

# iHealth<sup>®</sup>

## Lancing Device

### Intended Use

The iHealth Lancing Device and iHealth Lancets are specifically designed to use with the Gluco-Monitoring System. For collecting peripheral blood, it should be used with disposable Lancets.

*Important: The iHealth Lancing Device is for self-use only, and should not be used by healthcare professionals. Do not share or re-use lancets.*

### Part and Display

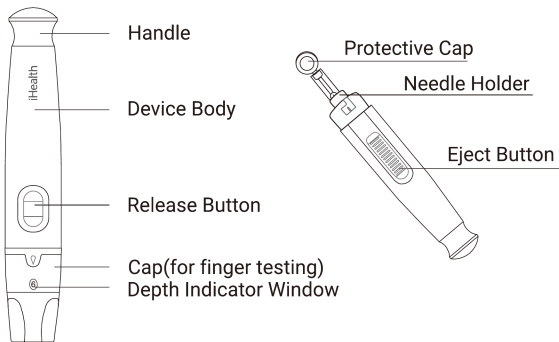

# Using the Lancing Device

## 1. Remove Cap

Pull off the cap of the Lancing Device.

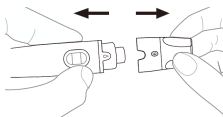

## 2. Insert Lancet

Insert a new lancet firmly into the white lancet needle holder.

*Notes: Pushing the lancet into the needle holder may cock the device. Do not use lancet if cap has been previously removed.*

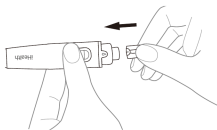

## 3. Twist Off the Protective Cap

Hold the lancet firmly with one hand; use your other hand to twist off the protective cap.

*Note: To avoid contamination, please dispose of the used protective cap in a puncture-resistant container. (Do not discard and save it for later use)*

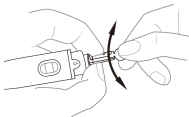

## 4. Replace Lancing Device Cap

Replace the cap until it clicks into place. Be careful not to touch the exposed needle on the lancet.

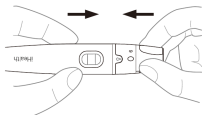

## 5. Set the Lancing Level

The lancing device has 9 different depth settings. Level 1 is the shallowest depth; Level 9 is the deepest depth. Twist cap to the desired setting as shown in the depth indicator window.

Lancing Depth Guide:

1~3 for soft/thin skin

4~6 for average skin

7~9 for thick/calloused skin



## 6. Load the Handle

Pull the lancing device handle until it clicks. The lancing device is now prepared and ready for use. The release button indicator on lancing device will turn red if the lancing device is properly launched.

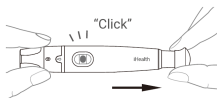

## 7. For Finger Lancing

- Lightly touch the lancing device (with the cap) against the side of your fingertip. For best results, lance in shaded areas.
- Press the Release Button.
- Gently squeeze your finger, if needed, until a blood drop the size of a pinhead forms (example: ●).
- Refer to your Owner's Manual for further information on blood glucose testing with the Gluco-Monitoring System.

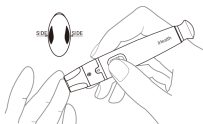

## 8. Removing a Used Lancet

- a. Prior to disposal, stick the lancet into the protective cap. Remove the Device Cap and stick the lancet tip into the Protective Cap.

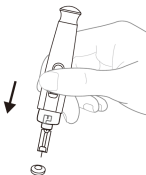

- b. Discard the used lancet properly.  
Push the Eject Button, then discard the used lancet in an appropriate container.

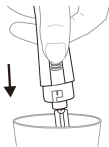

## Warning:

- Please avoid the accidental injuries to yourself or others when you use the device.
- Keep the lanceting device and the lancet away from children.
- When you install the lancet, please do not press the Release Button if the Device Cap is removed.
- Please do not keep the lancet in the device after using it.
- Please do not share the device with others or reuse the lancet.
- Please disinfect the device before using it, but do not immerse the device into any liquid.
- The lanceting device should press against the skin vertically and firmly, or it will affect the blood taking.

## Cleaning and Disinfection

Cleaning and disinfection is absolutely necessary for the test procedure to be accurate because cleaning can ensure the lancing device works well and disinfection can avoid infection or cross-infection to you or to other people.

We strongly recommend that the meter and lancing device be cleaned and disinfected following every use. We also suggest you use the following product: CaviWipes (EPA registration number: 46781-8)

CaviWipes, with Isopropanol and Diisobutyl-phenoxy-ethoxyethyl dimethyl benzyl ammonium chloride as the active ingredient, have been shown to be safe for use with the Glucose Meter and lancing device.

For product and technical information and to purchase this product visit [www.metrex.com](http://www.metrex.com) or contact Metrex at 1-800-841-1428.

- a. Before the test, the user should clean and wash hands.
- b. After testing, use the CaviWipes™ (Metrex® Research Corporation, EPA Reg. No.46781-8,EPA Est.No, 56952-WI-001) to clean and disinfect lancing device for 180 seconds.

### Note:

1. Each disinfection step requires a pre-cleaning step.
2. Do not immerse the body of the lancing device in water or any other liquid. Store in a dry, clean, well-ventilated room.
3. The users should wash hands thoroughly with soap and water after handling the lancing device.
4. If you have any questions please contact +1-855-816-7705.
5. Please refer to the following link for detailed information:

"FDA Public Health Notification: Use of Fingerstick Devices on More than One Person Poses Risk for Transmitting Bloodborne Pathogens: Initial Communication"

<https://wayback.archive-it.org/7993/20170111013014/>

<http://www.fda.gov/MedicalDevices/Safety/AlertsandNotices/ucm224025.htm>"Infection Prevention during Blood Glucose Monitoring and Insulin Administration."

<http://www.cdc.gov/injectionsafety/blood-glucose-monitoring.html>

Product Model: RC-AD-XII

Exp.Date: 5 years or normal use 3000 times, whatever occurs first.

Manufactured for iHealth Labs, Inc.

USA:

iHealth Labs, Inc. [www.ihealthlabs.com](http://www.ihealthlabs.com)

880 W Maude Ave, Sunnyvale, CA 94085, USA

+1-855-816-7705



Beijing Ruicheng Medical Supplies Co., Ltd.

Building 5, No. 8, Yanqi West Road, Yanqi Economic

Development Zone, Huairou District 101407 Beijing P.R. China

Tel: +0086-10-61678701

Fax: +0086-10-61678702

### Authorised representative in the European community









Lotus NL B.V.

Koningin Julianaplein 10, 1e Verd, 2595AA, The Hague, Netherlands.

E-mail : [peter@lotusnl.com](mailto:peter@lotusnl.com)

### Symbols:

	Manufacturer
	MFG date
	Batch number
	Consult instructions for use
	EXP date
	Authorised representative in the European community
	Complies with the requirements of the European MDR (EU)2017/745

Rev.04/2026