

iHealth[®] Lancing Device

Intended Use

The iHealth Lancing Device and iHealth Lancets are specifically designed to use with the GlucoMen[®] System. For collecting peripheral blood, it should be used with disposable Lancets.
Important: The iHealth Lancing Device is for self-use only, and should not be used by healthcare professionals. Do not share or re-use lancets.

Part and Display

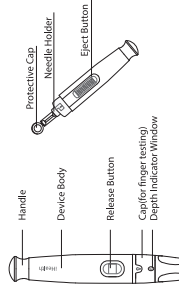

1

Using the Lancing Device

- Remove Cap**
Pull off the cap of the Lancing Device.
- Insert Lancet**
Insert a new lancet firmly into the white lancet needle holder.
Notes: Pushing the lancet into the needle holder may cock the device. Do not use lancet if cap has been previously removed.



- Twist Off the Protective Cap**
Hold the lancet firmly with one hand; use your other hand to twist off the protective cap.
Note: Do avoid contamination. Always flip over the used protective cap in a puncture resistant container. Do not discard and store it for later use!



- Replace Lancing Device Cap**
Replace the cap until it clicks into place. Be careful not to touch the exposed needle on the lancet.



2

5. Set the Lancing Level

The lancing device has 9 different depth settings. Level 1 is the default setting. Turn the lancet cap to the desired setting as shown in the depth indicator window.

- Lancing Depth Guide:
1-3 for soft/thin skin
4-6 for normal skin
7-9 for thick/calloused skin

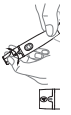

6. Load the Handle

Pull the lancing device handle until it clicks. The lancing device is now prepared and ready for use. The release button indicator on lancing device will turn red if the lancing device is properly launched.

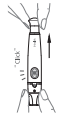

7. For Finger Lancing

- Lightly touch the lancing device (with the cap) against the side of your fingertip. For best results, lance in shaded areas.
- Press the Release Button.
- Clearly squeeze your finger. If needed, until a blood drop the size of a pea is formed.
- Refer to your Owner's Manual for further information on blood glucose testing with the Gluco-Monitoring System.



3

8. Removing a Used Lancet

- Prior to disposal, stick the lancet tip into the protective cap. Remove the Device Cap and stick the lancet tip into the Protective Cap.



- Discard the used lancet properly. Push the Eject Button, then discard the used lancet in an appropriate container.



Warning:

- Please avoid the accidental injuries to yourself or others when you use the device.
- Keep the lancing device and the lancet away from children.
- Do not use the lancing device if the Release Button does not work. Please do not press the Release Button if the Device Cap is removed.
- Please do not keep the lancet in the device after using it.
- Please do not share the device with others or reuse the lancet.
- Please do not use the device before using it, but do not immerse the device into any liquid.
- The lancing device should press against the skin vertically and firmly, or it will affect the blood taking.

4

Cleaning and Disinfection

Cleaning and disinfection is absolutely necessary for the test procedure. The lancing device should be cleaned and disinfected after each use. Proper cleaning and disinfection can avoid infection or cross-infection to you or other people.

We strongly recommend that the meter and lancing device be cleaned with 70% alcohol. For the lancing device, please use the following product: CavWipes (EPA registration number: 46781-18) CavWipes, with Isopropyl and Dibutyl-phenoxyethoxyethyl dimethyl benzyl ammonium chloride as the active ingredient, have been approved by the FDA for use as a disinfectant. For product and technical information and to purchase this product, visit www.merck.com or contact Merck at 1-800-841-1128.

After testing, use the CavWipes™ (Merck) Research Corporation, EPA Reg. No. 46781-18, EPA Est. No. 56952-MH-001) to clean and disinfect lancing device for 180 seconds.

Note:

- Each disinfection step requires a pre-cleaning step.
 - Do not immerse the body of the lancing device in water or any other liquid. Store in a dry, clean, well-ventilated room.
 - Handle the lancing device thoroughly with soap and water after handling the lancing device.
 - If you have any questions please contact +1-855-541-67705.
- Please refer to the following link for detailed information:
One Person Poses Risk for Transmitting Bloodborne Pathogens: Initial Communication
<https://www.fda.gov/oc/ohrt/one-person-poses-risk-for-transmitting-bloodborne-pathogens-initial-communication>
+1-855-541-67705
+1-855-541-67705
+1-855-541-67705
+1-855-541-67705
+1-855-541-67705
+1-855-541-67705
+1-855-541-67705
<http://www.cdc.gov/infectionsafety/about-glucose-monitoring.html>

5

Product Model: RCAD-XII
Exp. Date: 5 years or normal Use 3000 times, whatever occurs first.

Manufactured for Health Labs, Inc.
Health Labs, Inc.
www.healthlabs.com
San Jose, Sunnyvale, CA 94085, USA
+1-855-541-67705

Beijing Ruicheng Medical Supplies Co., Ltd.
Building 5, No. 8, Yong West Road, Yantai Economic
Development Zone, Hainan District 101407 Beijing PRC China
Tel: +8686-19-01076791 Fax: +8686-19-01076792

Authorised representative in the European community
Lotus NL B.V.
Konings Julianenplein 10, 1612 WD, 2595AA, The Hague, Netherlands.
Email: peter@lotus.nl

Symbols:

	Manufacturer
	MFG date
	Batch number
	Consult instructions for use
	EXP date
	Authorised representative in the European community (EU)2017745

Rev.01/2025

6